

Detached Villa in Mijas

Price **€ 1,650,000**

Plot Size

33600 m²

SETTING

- ✓ Village
- ✓ Close To Schools
- ✓ Mountain Pueblo
- ✓ Close To Forest
- ✓ Close To Shops

ORIENTATION

- ✓ East
- ✓ South East
- ✓ South

VIEWS

- ✓ Sea
- ✓ Panoramic
- ✓ Mountain
- ✓ Country

CATEGORY

- ✓ Investment
- ✓ Resale

Spectacular villa with panoramic sea views in Mijas Pueblo

Located in one of the most privileged areas of Mijas Pueblo, this elegant detached villa offers stunning panoramic views of the sea and coastline, combining privacy, spaciousness, and an excellent location just minutes from the charming town center.

Built in 2004 on a 645 m² plot, the property has 257 m² of floor space distributed in spacious and bright rooms. It has 3 bedrooms and 4 bathrooms, offering comfort and functionality for both a permanent residence and a vacation home.

The main living room is spacious and cozy, with large windows framing spectacular views of the Mediterranean and direct access to the terraces. The house combines traditional elements such as exposed brick arches and wooden beamed ceilings with open spaces and plenty of natural light.

Outside, there is a magnificent private swimming pool surrounded by large sunny terraces, perfect for enjoying the Costa del Sol climate all year round. The property offers different covered and uncovered outdoor areas ideal for relaxation and entertainment, all with uninterrupted views.

The kitchen is spacious and functional, and the property also has a laundry area, several terraces (approx. 40 m²) and private parking.

An ideal property for those seeking tranquility, spectacular views, and proximity to all the amenities, restaurants, and traditional charm of Mijas Pueblo, just 15 minutes from the beach and 25 minutes from Malaga airport.

[View Property Online](#)

GALLERY

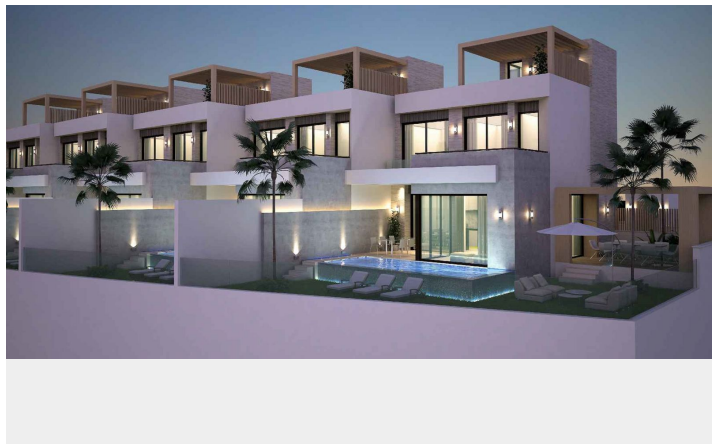
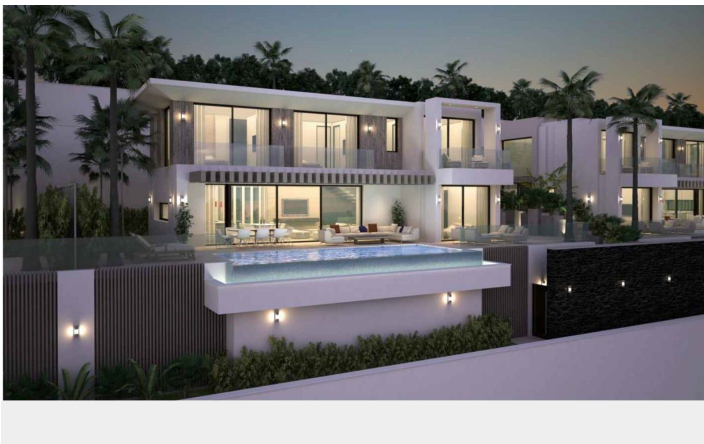
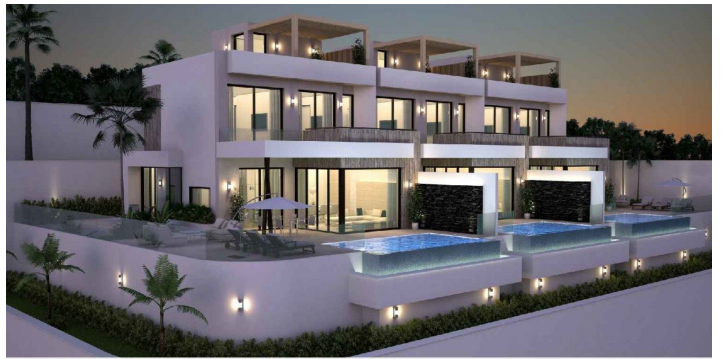

Vivi Real Estate | Calle Almendralejo de Jarales 5 Mijas Costa, 29640

Tel: +34 672 816 975

Email: sales@vivi-realestate.com | Web: www.vivi-realestate.com